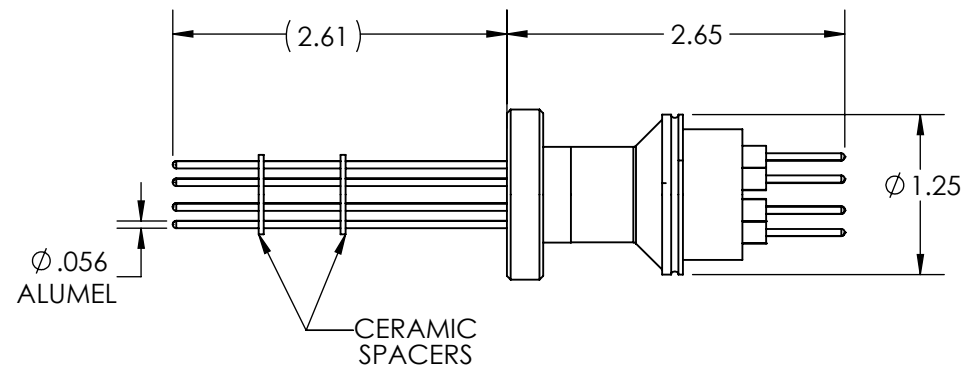
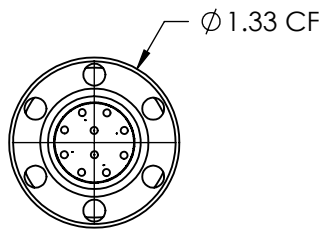
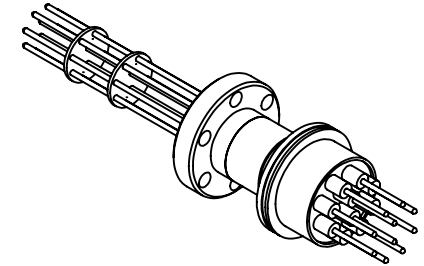

A0423 POWER

REV  
8/21/2013

PART #	# OF PINS
A0423-4-CF	4
A0423-8-CF	6
A0423-12-CF	10

APPROVED

Power Feedthrough, 2000 Volts, 10 Amps, 4, 6 and 10 Pins, 0.056" Alumel Conductors, 1.33" Conflat Flange

TITLE:

POWER, 2KV, 10A, 4, 6 AND 10 PIN  
ALUMEL, 133CF

PROPRIETARY AND CONFIDENTIAL

UNLESS OTHERWISE SPECIFIED:

MPF PRODUCTS INC.

ANY REPRODUCTION IN PART OR AS A WHOLE WITHOUT THE  
WRITTEN PERMISSION OF MPF PRODUCTS INC. IS PROHIBITED.

USED ON:

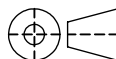
DIMENSIONS ARE IN INCHES  
TOLERANCES:ANGULAR: MACH  $\pm 1/2^\circ$   
TWO PLACE DECIMAL  
THREE PLACE DECIMAL $\pm .030$   
 $\pm .015$ FINISH  
CONFLAT

DO NOT SCALE DRAWING

DRAWN BY

JB

DATE

CHECKED

ENG APPR.

JB

SIZE  
**A**DWG. NO.  
**A0423 POWER**

REV

8/21/2013

LAST SAVED DATE

Wednesday, August 21, 2013 7:07:54 AM